



# A.A.G. STUCCHI

## Essential for lighting



A.A.G. STUCCHI s.r.l. u.s.  
Via IV Novembre 30/32,  
23854 Olginate (LC) Italy  
Ph. +39 0341 653111  
Fax +39 0341 653250  
www.aagstucchi.it  
info@aagstucchi.it

### 265/TR



## PORTALAMPADE A COLONNA PER LAMPADE FLUORESCENTI LINEARI T5 TOMBSTONE LAMPHOLDER FOR T5 FLUORESCENT LINEAR LAMPS

### Dati tecnici

#### Technical data

- Attacco lampada	G5
- Lamp cap	
- Corrente e tensione nominale	2A-500V
- Rated current and voltage	
- Temperatura massima di funzionamento (IEC)	T110
- Maximum operating temperature (IEC)	
- Grado di protezione	IP20
- Protection index	
- Categoria di sovratensione	III
- Impulse withstand category	

### Caratteristiche

#### Characteristics

- Corpo in policarbonato trasparente
- Transparent polycarbonate body
- Contatti in lega di rame
- Copper alloy contacts

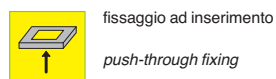
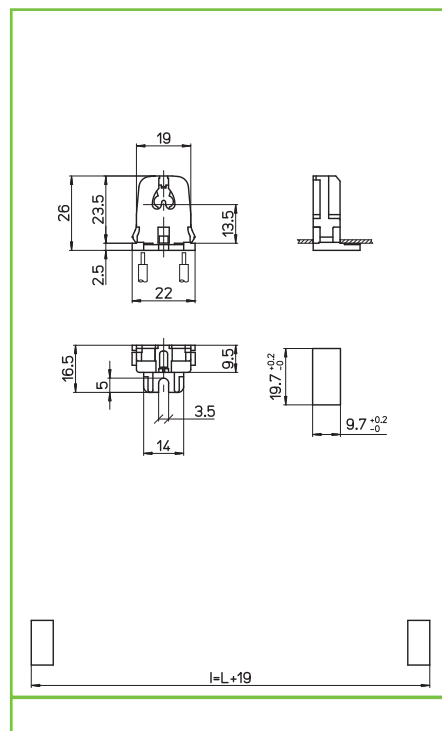

fissaggio ad inserimento  
push-through fixing

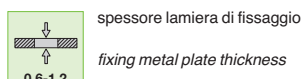

spessore lamiera di fissaggio  
fixing metal plate thickness

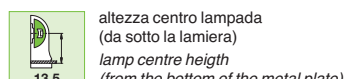

altezza centro lampada  
(da sotto la lamiera)  
lamp centre height  
(from the bottom of the metal plate)



fissaggio con vite  
screw fixing

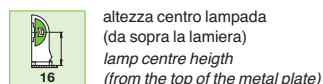

altezza centro lampada  
(da sopra la lamiera)  
lamp centre height  
(from the top of the metal plate)

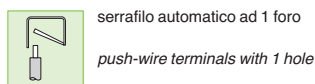

serrafilo automatico ad 1 foro  
push-wire terminals with 1 hole

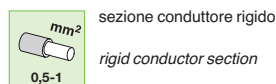

sezione conduttore rigido  
rigid conductor section

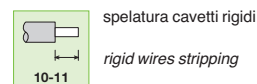

spelatura cavetti rigidi  
rigid wires stripping

### Marchi di qualità Quality marks

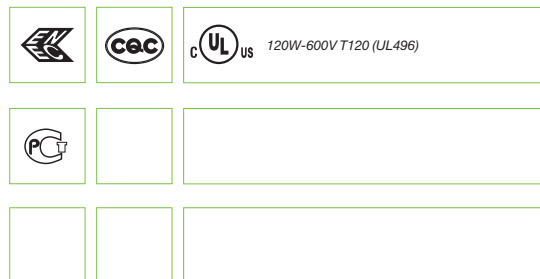

### Direttive Europee European directives

Conforme "RoHS"  
"RoHS" compliant  
Non soggetto alla "RAEE"  
Not subject to "WEEE"

### Pesi e confezioni Weights and packaging

Art. codice prodotti product references	g peso netto net weight	pezzi per sacco pieces per bag	pezzi per scatola pieces per box
265/TR	3,3	1000	

Note  
Notes